



COATING-COTTON ROPE

Cotton rope



Flexibility
Softness
Whiteness / neutral color

Can't stand by its own



Capillary action : it can be dye

Flour based glue



60 gr. wheat flour
10 gr. white sugar
12 cl. water

12 cl. extra water

- 1/ Mix water, wheat flour and sugar.
- 2/ Warm it slowly until it thicken.
- 3/ Dilute with the rest of water.
- Faculative/ Add spices or natural dye.
- 4/ Let cool.



ROPE-COATING PROCESS

Coating rope

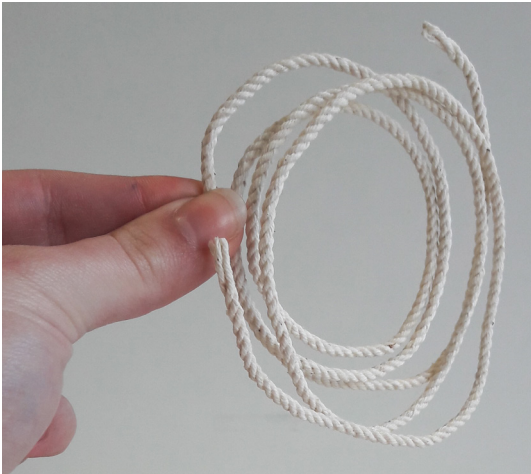

Hardened
Semi- rigid
Roughness
Lightness



Maizena based glue

Flour based glue

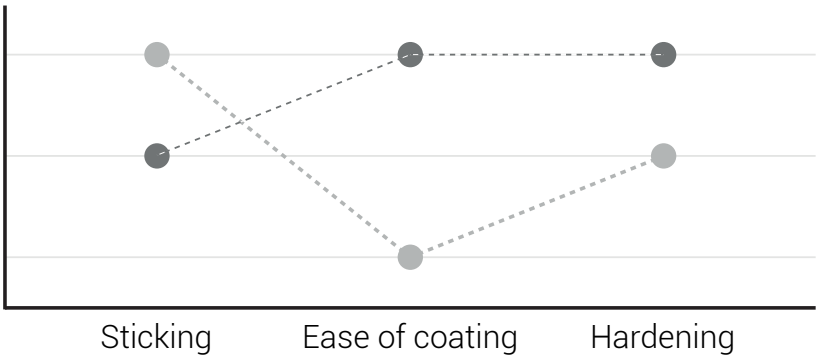

Plastic properties

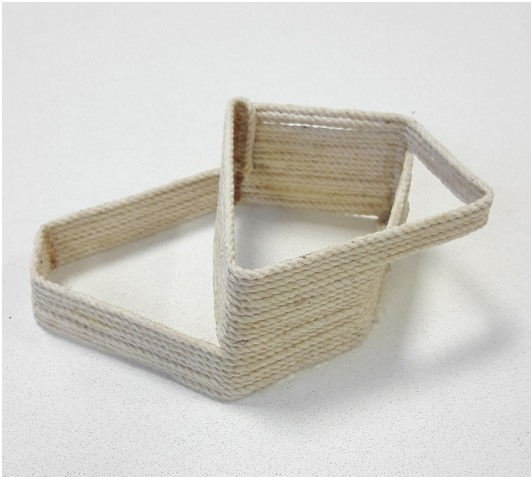

Volume from a soft and fragile material
Structure is the object : it creates itself its line



Contrast between what it seems and what it is : a limp rope which is now able to stand by its own thanks to the coating and its lightness (volume doesn't collapse under its weight).

Processes

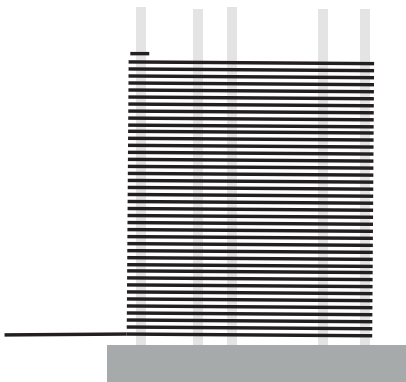

Winding

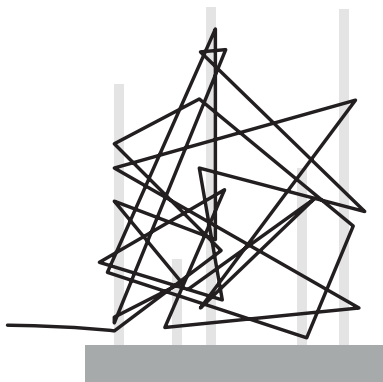

Manual random spooling

ROPE-COATING MACHINE

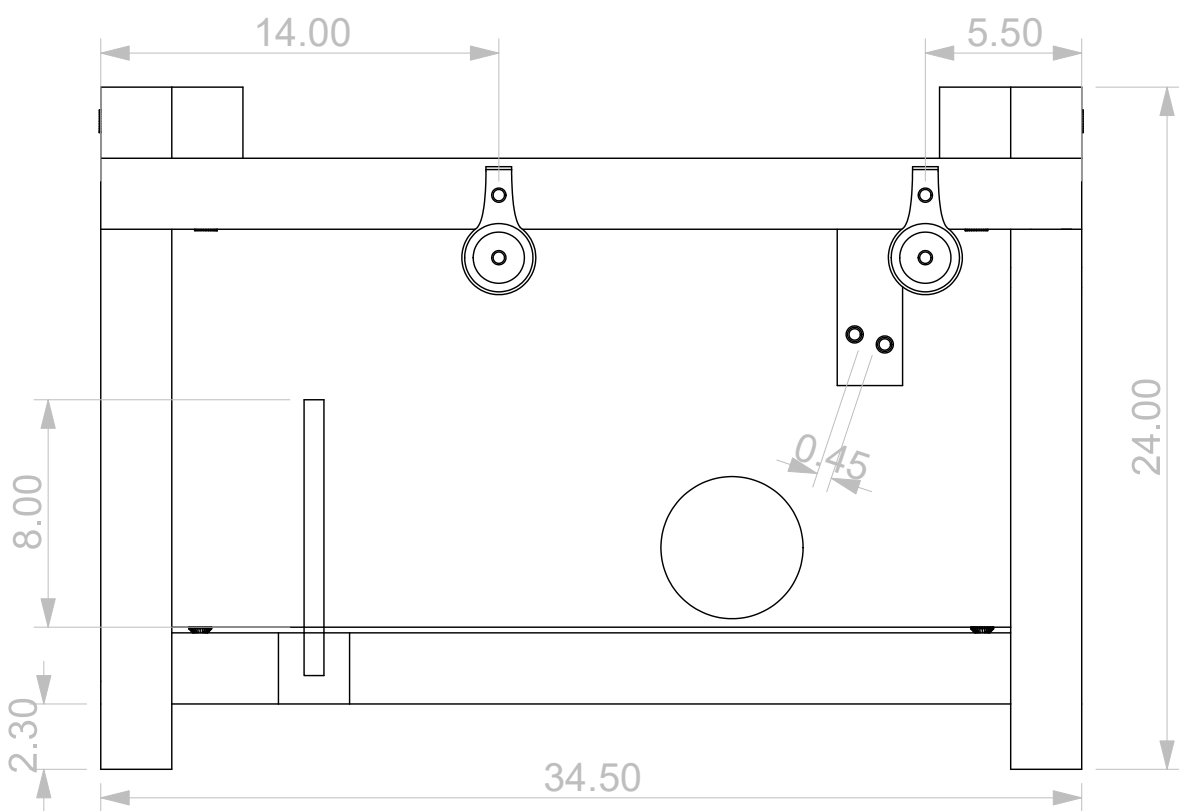
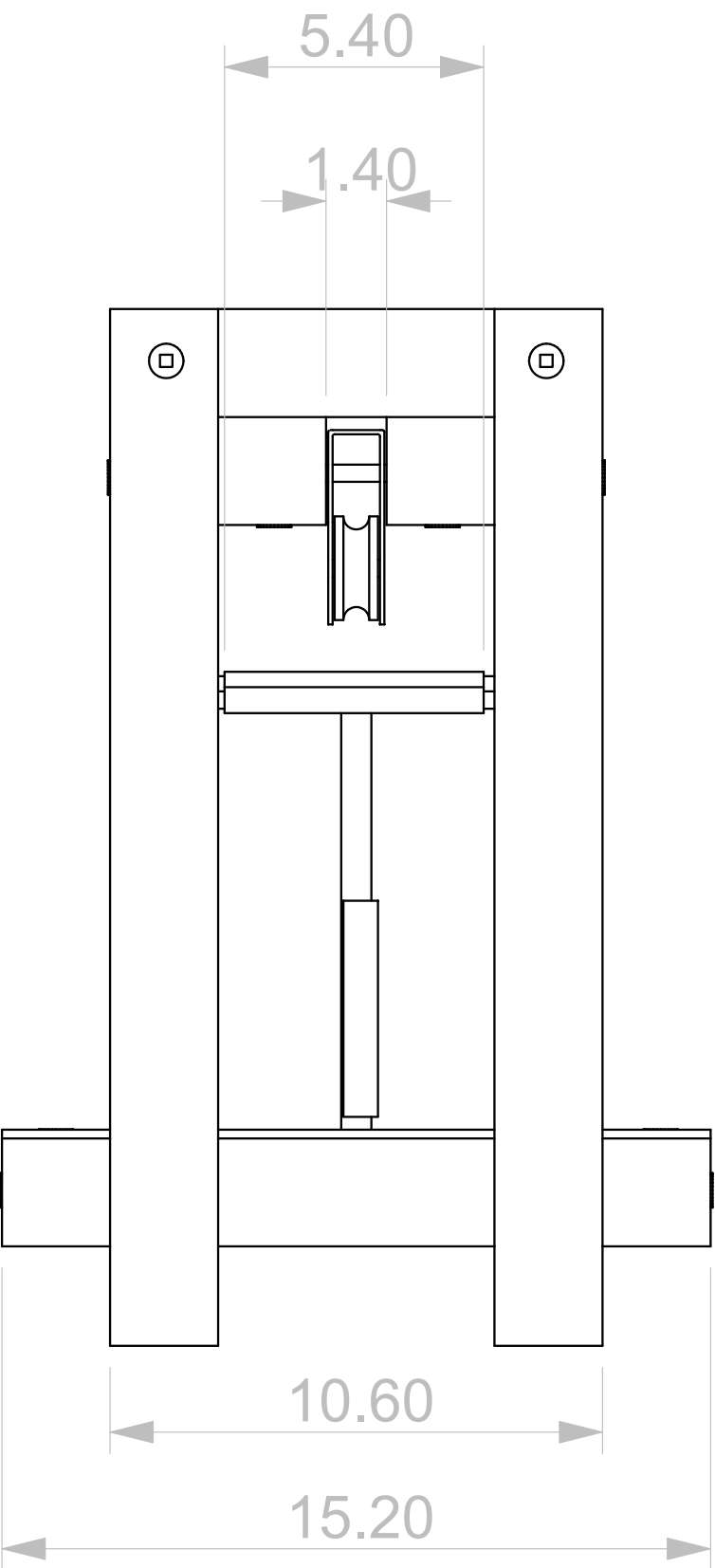

Structure

2.3x2.3cm cleats

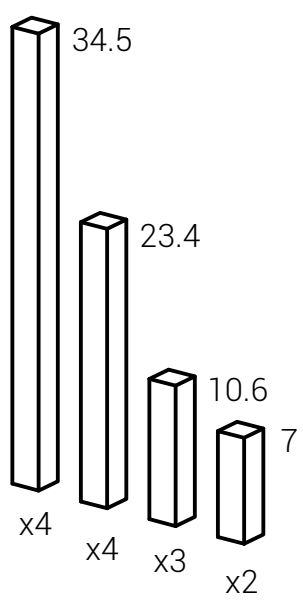

31.1x15.2 Isorel plate

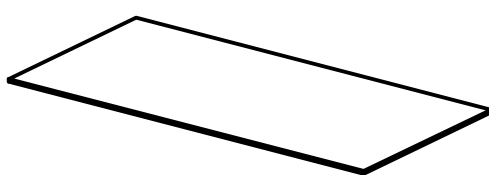

Iron stems

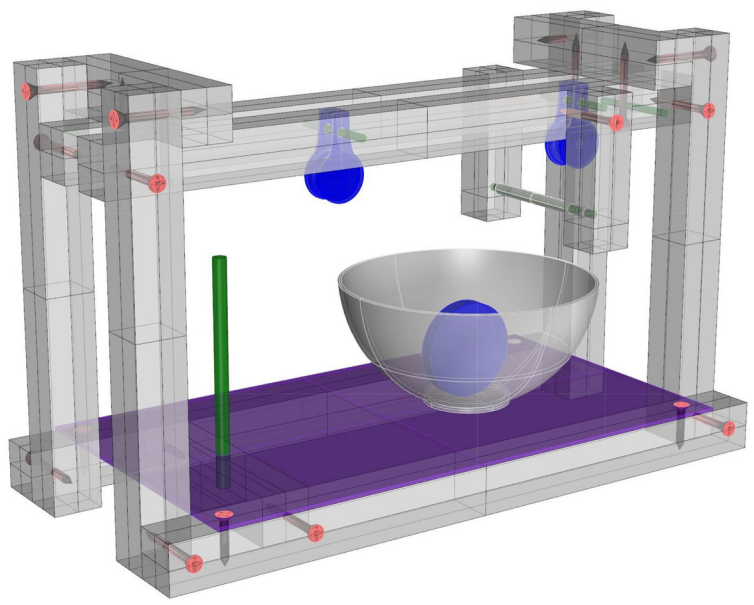
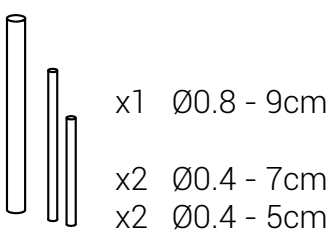

Moving pieces

Wringing roll



Pulley

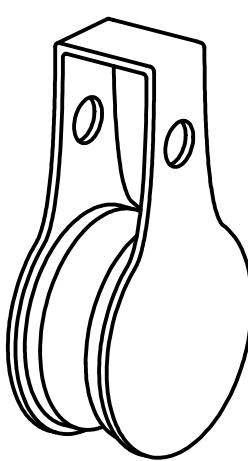

Heavy wheel

